

# CPU HOLDERS

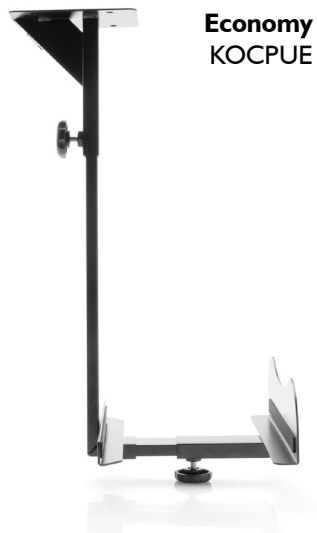

**Economy  
KOCPU**



**Easy Cinch  
CPU.SLING**



**Standard  
KOCPU**



**Standard with Lock  
KOCPU**

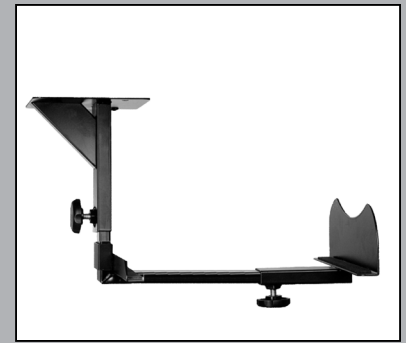

The Economy holder is available in a horizontal or vertical configuration to accommodate CPU towers or horizontal desktops.



A locking nut that requires a pentagonal key helps ensure your vital hardware will stay right where you left it.



The track of the Standard and Locking CPU holders can be top-mounted to the surface or side-mounted to end panels or legs.



Secure straps and buckles on the Easy Cinch CPU holder make installation as simple as adjusting the straps on a backpack.

Have it all. Keep your CPU out of harm's way and within reach with a worksurface-mounted CPU holder. The **Economy** holder makes safe, secure storage available for everyone. It is adjustable to accommodate a CPU tower (from 15.5 x 5.5" to 20 x 9.8") in vertical configuration as easily as a horizontal desktop (from 7.3 x 13.8" to 11.3 x 18.8").

The **Easy Cinch** holder uses a set of straps and buckles to make installation a snap. Pulling the straps tight provides enough tension on them to keep the CPU in place. The Easy Cinch and Standard holders also allow you to

swivel the computer 360° to access ports on the rear panel.

The **Standard & Standard Locking** holders feature an adjustable side clamp that holds the CPU upright securely on a tray. They accommodate processors from 14.5 x 3.5" to 22.5 x 9.3" and include a track to allow the CPU to slide back and out of the way.

The **Standard Locking** holder includes a removable security knob with a tamper-proof locking nut to prevent theft and solid wire clasps on the bottom tray to prevent unwanted fore/aft movement.

# CPU HOLDERS

## Economy (vertical) KOCPU

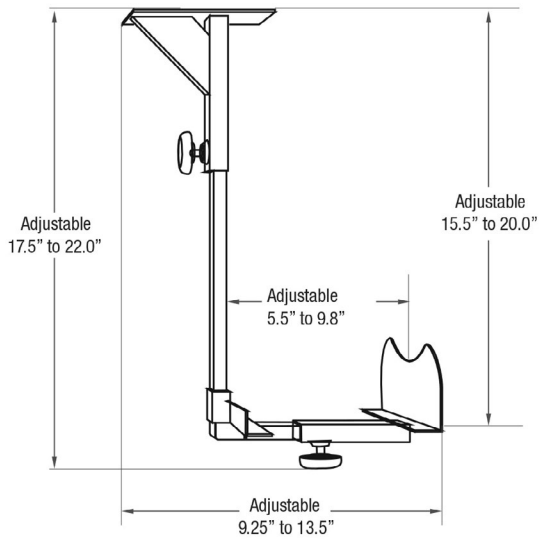

## Easy Cinch CPU.SLING

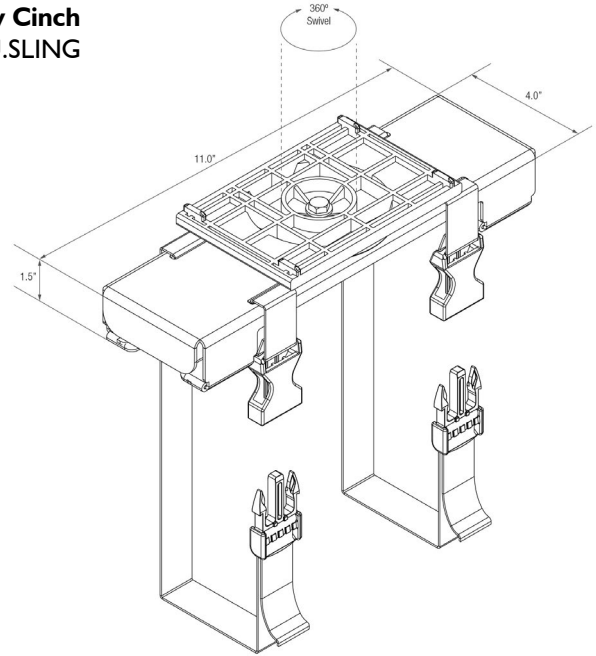

## Economy (horizontal) KOCPU

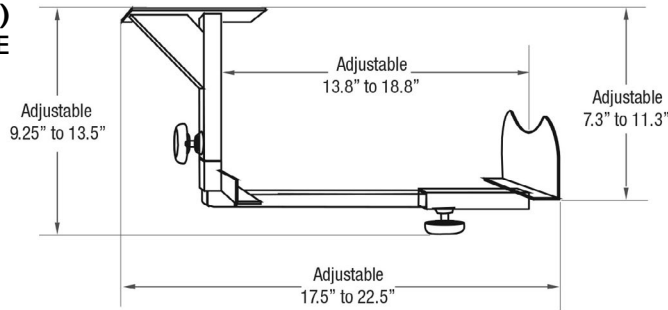

## Standard with Lock KOCPL

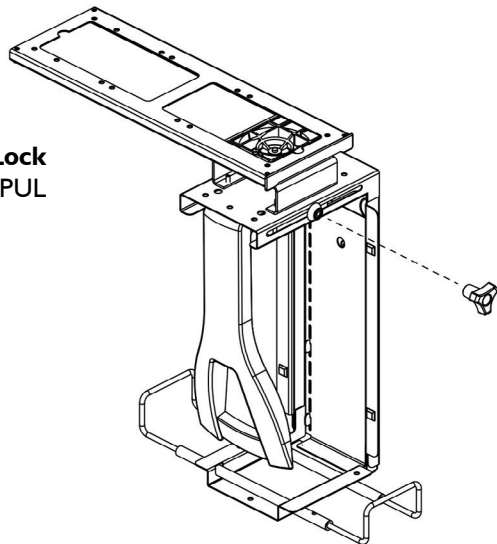

## Standard KOCPU

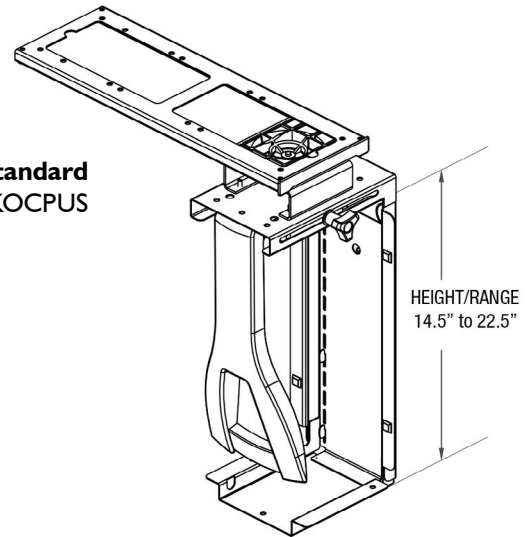

(lockable)

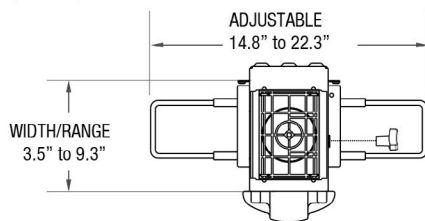

(non-lockable)

